

CLF5030NIT-D Series

Automotive Grade Wound Ferrite Power Inductors

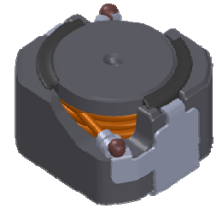

TDK's newly developed CLF-NI-D series power inductors are magnetically shielded, wire wound inductors with a magnetic ferrite core, designed for use in automotive applications. This series features a robust high-reliability design with highly heat-resistant wire and wire connections, resulting from the use of welding material that does not melt during the reflow process. A fully automated manufacturing process also ensures that all finished CLF-NI-D products are of uniform high quality. CLF-NI-D series power inductors are available in a variety of case sizes and inductance values and are AEC-Q200 compliant, meaning they can be used in a wide temperature range and in extreme environments such as the automotive engine bay.

Features

- Robust design – Generic use for Automotive application
- High magnetic shield construction features low EMI
- Wide inductance range—1.0 μ H-470 μ H, E-6 Series lineup
- Operating temperature and storage temperature range of -55°C to +150°C (including self temperature rise)

Applications

- ECM / ECU
- SRS Air bag
- Head light module
- Transmission control
- Power steering control
- ADAS etc.

Power

Wire wound

AEC-Q200



[Datasheet Link](#)

CLF5030NIT-D Series Automotive Power Inductors

Case Size:	5.3x5.0x2.7mm
Inductance Range:	1.0uH-6.8uH +/- 30%, 10uH-470uH +/- 20%
Isat*:	0.24-5.0A
Itemp*:	0.17-3.7A
DC Resistance:	0.019-5.28 Ω max.

*Isat : Depends on Inductance Saturation. (-30% Reduction from Nominal L Value)

*Itemp : Depends on Self Temperature Rise (40deg.C)

2,000 pieces per reel